

COLDBROOK LLC
3587/141

FORMERLY PART OF LOT #12
BEAR MOUNTAIN PLAN OF LOTS
PLAN FILE 2005, PAGE 122

MCPHERSON TIMBERLANDS LLC

3348/168
3636/101
84± ACRES

- 1.) ORIENTATION IS UTM ZONE 19, NAD 83 GRID
- 2.) REFERENCE IS MADE A PLAN OF A SUBDIVISION ENTITLED "BEAR MOUNTAIN - PLAN OF LOTS" DATED 7/19/2005 AND RECORDED IN PLAN FILE 2005 -122 IN THE SOMERSET REGISTRY OF DEEDS.
- 3.) MEASUREMENTS SHOWN ON THIS PLAN WERE PERFORMED WITH TOPCON PATHFINDER AND GRS-1 GPS RECEIVERS. THE MANUFACTURER INDICATES THAT UNDER OPTIMUM CONDITIONS, PRECISIONS OF LESS THAN ONE METER ARE ACHIEVABLE.

- LEGEND**
- IRON PIPE/PIN FOUND (AS NOTED)
 - ▲ WOODEN POST FOUND
 - GRANITE MONUMENT FOUND
 - BLAZED/PAINATED TREE
 - BOOK/PAGE REFERENCE
 - TAX MAP-LOT NUMBER REFERENCE
 - 5/8" REBAR WITH CAP LABELLED "MUR PLS 1297" COPY SET
 - STONE WALL

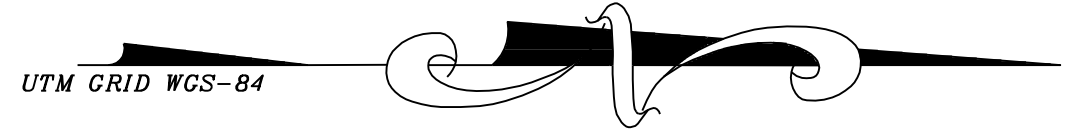

DATE: 11/16/2015
SP-01
PROJECT NO. 15432

Ken Muir & Associates
LAND SURVEYORS
PHONE: 207-659-3642
www.kenmuirassociates.com
153 Storer Road
Bradford, ME. 04410

MCPHERSON TIMBERLANDS, LLC
1182 ODLIN ROAD
(RECORD OWNER)
BANGOR, MAINE 04401

REV.	DATE	DESCRIPTION

DRAWN BY: _____ CHECKED BY: _____

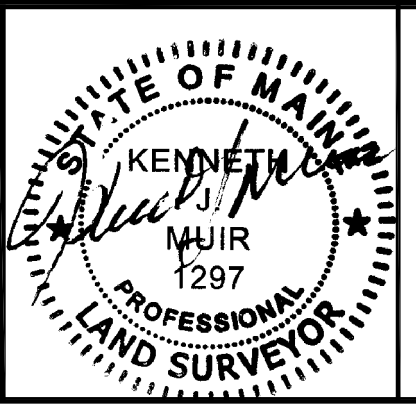

PLAN OF LAND TO BE SOLD
BY
McPHERSON TIMBERLANDS, LLC
BEAR MOUNTAIN ROAD
FAIRFIELD MAINE